

**vtech**<sup>®</sup>  
Baby

# User's Manual

## Too-Too Drivers Garage

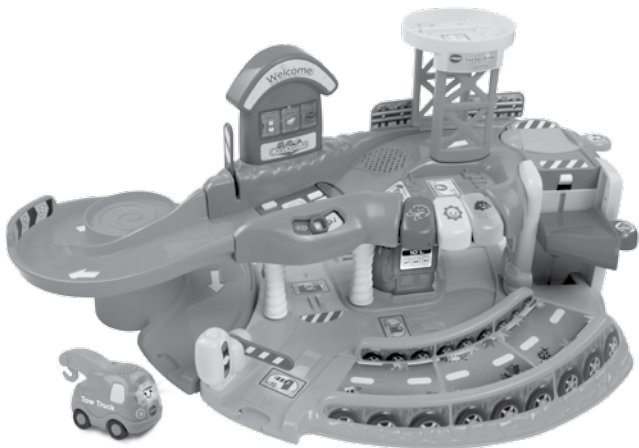

© 2013 VTech  
Printed in China  
91-002594-020 UK

**VTech understands that a child's needs and abilities change as they grow and with that in mind we develop our toys to teach and entertain at just the right level...**

## **vtech Baby**

**Toys that will stimulate their interest in different textures, sounds and colours**

### **I am...**

...responding to colours, sounds and textures

...understanding cause and effect

...learning to touch, reach, grasp, sit-up, crawl and toddle

*Birth-36 months*



## **Pre-School**

**Interactive toys to develop their imagination and encourage language development**

### **I want...**

...to get ready for school by starting to learn the alphabet and counting

...my learning to be as fun, easy and exciting as can be

...to show my creativity with drawing and music so my whole brain develops

*3-6 years*



## **Electronic Learning Computers**

**Cool, aspirational and inspiring computers for curriculum related learning**

### **I need...**

...challenging activities that can keep pace with my growing mind

...intelligent technology that adapts to my level of learning

...National Curriculum based content to support what I'm learning at school

*4-10 years*



To learn more about this and other VTech® products, visit [www.vtechuk.com](http://www.vtechuk.com)

# INTRODUCTION

Thank you for purchasing the **VTech® Toot-Toot Drivers Garage** learning toy.

The **Toot-Toot Drivers Garage** is a fun interactive toy for little ones to enjoy! Drive the cute Tow Truck around the garage to trigger lots of fun responses and interactive phrases about the petrol station, car wash, turntable and exit gate. There's even a magic sensor and 6 SmartPoint locations that will recognise different **Toot-Toot Drivers** vehicles. Roll the Tow Truck down the winding ramp for extra fun! With realistic sounds, cute songs and phrases learning has never been so much fun!

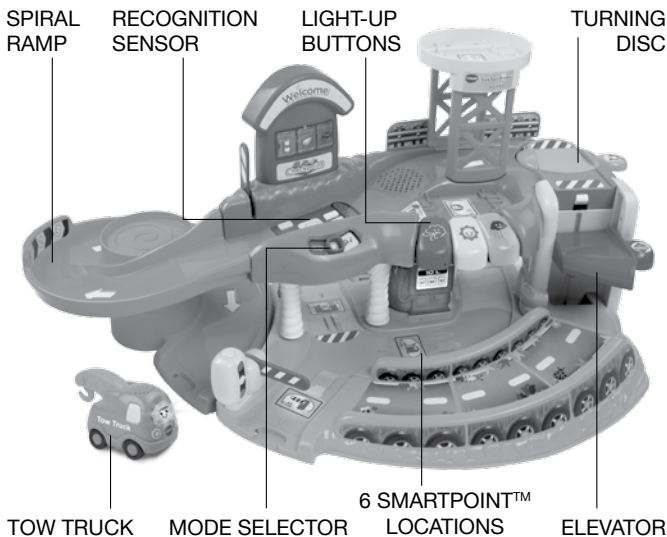

# INCLUDED IN THIS PACKAGE

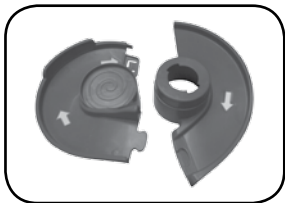

Two spiral ramp tracks



One main unit



One checkpoint sign



One traffic stop

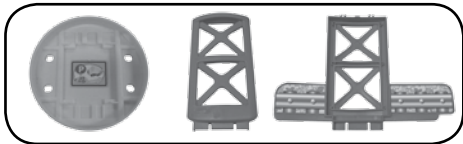

Three helicopter pad pieces



One tow truck



One support

One instruction manual

**WARNING:** All packing materials, such as tape, plastic sheets, packaging locks and tags are not part of this toy, and should be discarded for your child's safety.

**Note:** Please keep this instruction manual as it contains important information.

**Unlock the packaging locks:**

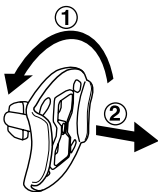

① Rotate the packaging lock 90 degrees anti-clockwise

② Pull out the packaging lock

## GETTING STARTED

### BATTERY INSTALLATION

1. Make sure the unit is turned **OFF**.
2. Locate the battery cover on the back of the main unit and the bottom of the tow truck. Use a coin or screwdriver to loosen the screws.
3. Install 2 new AA (AM-3/LR6) batteries following the diagram inside the main unit battery box (a). Install 2 new AAA (AM-4/LR03) batteries following the diagram inside the tow truck battery box (b). The use of new alkaline batteries is recommended for maximum performance.
4. Replace the battery covers and tighten the screws to secure.

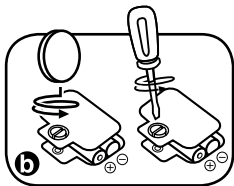
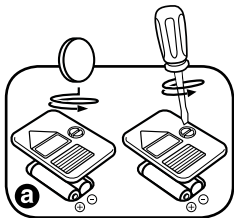

## BATTERY NOTICE

- Use new alkaline batteries for maximum performance.
- Use only batteries of the same or equivalent type as recommended.
- Do not mix different types of batteries: alkaline, standard (carbon-zinc) or rechargeable (Ni-Cd, Ni-MH), or new and used batteries.
- Do not use damaged batteries.
- Insert batteries with the correct polarity.
- Do not short-circuit the battery terminals.
- Remove exhausted batteries from the toy.
- Remove batteries during long periods of non-use.
- Do not dispose of batteries in fire.
- Do not charge non-rechargeable batteries.
- Remove rechargeable batteries from the toy before charging (if removable).
- Rechargeable batteries are only to be charged under adult supervision.

## DO NOT USE RECHARGEABLE BATTERIES.

### Disposal of batteries and product



The crossed-out wheellie bin symbols on products and batteries, or on their respective packaging, indicates they must not be disposed of in domestic waste as they contain substances that can be damaging to the environment and human health.



The chemical symbols Hg, Cd or Pb, where marked, indicate that the battery contains more than the specified value of mercury (Hg), cadmium (Cd) or lead (Pb) set out in Battery Directive (2006/66/EC).

The solid bar indicates that the product was placed on the market after 13th August, 2005.

Help protect the environment by disposing of your product or batteries responsibly.

For more information, please visit:

[www.recycle-more.co.uk](http://www.recycle-more.co.uk)

[www.recyclenow.com](http://www.recyclenow.com)

# ASSEMBLY INSTRUCTIONS

With the VTech® Toot-Toot Drivers Garage safety comes first. To ensure your child's safety, adult assembly is required.

1. Insert the traffic stop into the slot on the bottom-left of the main unit.

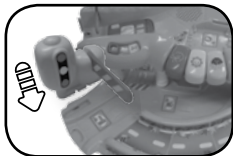

2. Insert the checkpoint sign into the slot on the top-left of the main unit.



3. Insert the two sides of the helicopter pad into the corresponding slots on the helicopter pad platform (a). Then, insert the entire helicopter pad into the corresponding slots on the main unit (b).

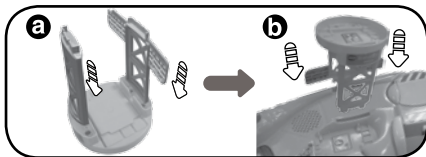

4. Put the top spiral ramp track on top of the bottom spiral ramp track, joining the two tracks in the centre (c). Then, twist the top spiral ramp track to lock it to the bottom spiral ramp track (d). Finally, attach the assembled spiral ramp to the top and bottom of the main unit (e).

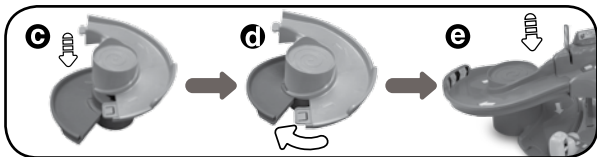

5. Insert the support into the slot on the underside of the turning disc platform.

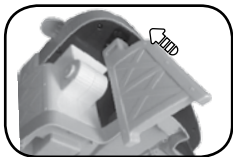

## PRODUCT FEATURES

### 1. MODE SELECTOR

To turn the unit **ON**, slide the **MODE SELECTOR** to the Learning Mode (📖) or Music Mode position (🎵). To turn the unit **OFF**, slide the **MODE SELECTOR** to the **OFF** position (**OFF**).

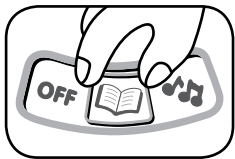

### 2. SMARTPOINT™ LOCATIONS

The Garage play set includes 6 SmartPoint™ locations that can be recognised by **Toot-Toot Drivers** vehicles to trigger fun sounds, phrases and music. (SmartPoint™ vehicles only, sold separately.)





### 3. AUTOMATIC SHUT-OFF

To preserve battery life, the **VTech® Toot-Toot Drivers Garage** will automatically power-down after approximately 30 seconds without input. The unit can be turned on again by pressing any button.

## ACTIVITIES - GARAGE

1. Slide the mode selector to turn on the unit. You will hear a sing-along song, phrase and sounds in **Learning Mode**. In **Music Mode**, you will hear a fun phrase, a sing-along song and sounds. The lights will flash with the sounds.
2. Press the three light-up buttons to learn colours and about the weather in **Learning Mode**. In **Music Mode**, hear phrases, sounds and melodies. The lights will flash with sounds.
3. Push a vehicle over one of the 6 **SmartPoint™** locations to hear the vehicle play a related phrase, sound or melody. (SmartPoint™ vehicles only, sold separately.)
4. Put a vehicle on the **elevator** platform. Move the elevator to learn opposites in **Learning Mode**. You'll hear sounds in **Music Mode**. The lights will flash with the sounds.

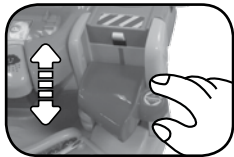
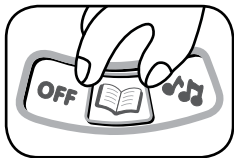

5. Put a vehicle on the turning disc. Turn the **disc** to hear sounds, phrases and sing-along songs in **Learning Mode**. Hear sounds, phrases and melodies in **Music Mode**. The lights will flash with the sounds.
6. While a vehicle is on the **recognition sensor**, press down or quickly push the vehicle through the gate to hear a greeting. The lights will flash with the sounds.

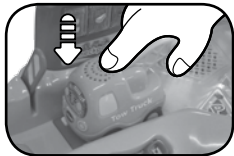
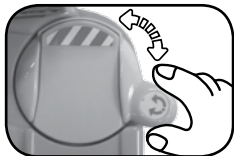

## ACTIVITIES - TOW TRUCK

1. Slide the **ON/OFF SWITCH** to the **ON** position to turn the unit **ON**. You will hear a song, a phrase and sounds. The light will flash with the sounds.
2. Press the **LIGHT-UP BUTTON** to hear vehicle sound effects, a song and phrases. The light will flash with the sounds.
3. Push the vehicle to hear fun sounds, a song and short tunes. While the short tune is playing, push the vehicle again to stop the short tune and play it with a faster tempo. The light will flash with sounds.

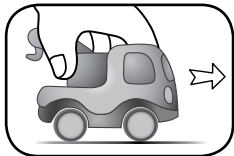
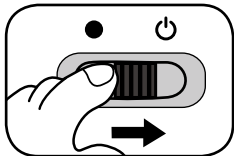

# MELODY LIST:

## Garage

1. The Wheels on the Bus
2. Bicycle Built for Two
3. Skip to My Lou
4. She'll Be Coming  
'Round the Mountain
5. The Alphabet Song
6. Bingo

## Tow Truck

1. The Wheels on the Bus
2. Humpty Dumpty
3. I've Been Working on the  
Railroad
4. Little Boy Blue
5. Jack & Jill
6. Old King Cole

# SING-ALONG SONG LYRICS

## Garage

### SING-ALONG SONG 1:

I'm a small garage,  
but I can do big things!  
Need a rest?  
Don't forget me!  
I'm here to help you!!

### SING-ALONG SONG 2:

Welcome friends,  
music is fun!  
Listen to the music,  
all day long

## Tow Truck

### SING-ALONG SONG 1:

I love picking up broken cars,  
With the magic hook on my roof.  
Call me, I'm on the way,  
beep-beep,  
I'm rushing to clear the way!

### SING-ALONG SONG 2:

I'm a useful tow truck,  
always ready to tow the cars!

### SING-ALONG SONG 3:

ABCD,

Watch out for the traffic lights,

look both ways!

Drive safely

Drive happily!

## CARE & MAINTENANCE

1. Keep the unit clean by wiping it with a slightly damp cloth.
2. Keep the unit out of direct sunlight and away from any direct heat source.
3. Remove the batteries when the unit will not be in use for an extended period of time.
4. Do not drop the unit on hard surfaces and do not expose the unit to moisture or water.

## TROUBLESHOOTING

If for some reason the program/activity stops working or malfunctions, please follow these steps:

1. Please turn the unit **OFF**.
2. Interrupt the power supply by removing the batteries.
3. Let the unit stand for a few minutes, then replace the batteries.
4. Turn the unit **ON**. The unit should now be ready to play again.
5. If the product still does not work, replace with an entire set of new batteries.

If the problem persists, please call our Consumer Services Department on 01235 546810 (from UK) or +44 1235 546810 (outside UK) and a service representative will be happy to help you.

**IMPORTANT NOTE:**

Creating and developing **VTech®** products is accompanied by a responsibility that we take very seriously. We make every effort to ensure the accuracy of the information, which forms the value of our products. However, errors sometimes can occur. It is important for you to know that we stand behind our products and encourage you to call our Consumer Services Department on 01235 546810 (from UK) or +44 1235 546810 (outside UK), with any problems and/or suggestions that you might have. A service representative will be happy to help you.



**CLASS 1  
LED PRODUCT**



## PRODUCT WARRANTY



Thank you for choosing this quality product from VTech. We hope it will bring many hours of entertainment, imaginative play and learning.

1. The product detailed above is covered by a one year warranty from the date of purchase, against any defects in materials or workmanship.
2. The product may be returned to the place of purchase. Alternatively the product can be returned to VTech Electronics Europe plc (see address below), with proof of purchase, without proof of purchase no replacement will be provided.
3. VTech Electronics Europe plc will examine the product and if it is found to be defective due to faulty materials or workmanship, will replace the product at their discretion.
4. If the product covered by this warranty is damaged due to misuse, modification or unauthorised repair, or because of faulty batteries, battery discharge or incorrect electrical connections, then this warranty becomes void.
5. This warranty is personal to the original purchaser and is not transferable.
6. Breakages to the LCD screen are not covered by the warranty.
7. Returns to VTech Electronics Europe plc should include a cheque or postal order for £1.50 towards the cost of return postage and packaging.
8. Products returned to VTech Electronics Europe plc, should be addressed as follows and packed carefully to avoid damage in transit (Please do not include batteries or adaptor).  
Please include details of the fault together with your name and address.

VTech Electronics Europe plc, c/o Tablogix Limited, 200 Milton Park, Abingdon, Oxon OX14 4TA

THIS WARRANTY IS OFFERED AS AN EXTRA BENEFIT AND DOES NOT AFFECT CONSUMERS' STATUTORY RIGHTS.

This warranty is valid for the UK and Eire only. For products purchased outside the UK and Eire, please contact your local distributor or place of purchase.

